

WEST POINT HILLS

A SUBDIVISION OF PART OF THE NE 1/4 OF SECTION 18,
T1N-R5E, HAMBURG TOWNSHIP, LIVINGSTON COUNTY, MICHIGAN

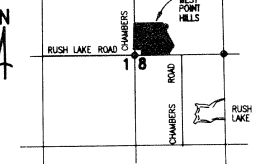
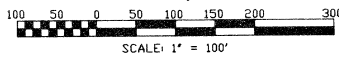

NOTE:
All drain easements and detention area are under the jurisdiction of the Livingston County Drain Commission.

This plat is subject to restrictions required by Act 288 of 1967, as amended on certain lots with respect to the requirements of the Michigan Department of Natural Resources and/or the Michigan Department of Public Health, which are recorded in Liber 1375, pages 270-277.

CURVE DATA

NO.	RADIUS	DELTA	ARC	CHORD	BEARING
1	20.00	92°04'10"	32.14	28.79	S 47°59'53" E
2	20.00	87°55'50"	30.69	27.77	N 42°00'07" E
3	20.00	90°00'00"	31.42	28.28	S 48°01'58" E
4	20.00	90°00'00"	31.42	28.28	N 48°01'58" E
5	20.00	90°00'00"	31.42	28.28	S 48°01'58" E
6	20.00	90°00'00"	31.42	28.28	N 48°01'58" E
7	229.00	22°52'51"	91.45	90.84	N 74°21'36" E
8	50.00	89°03'36"	77.72	70.13	N 14°23'22" E
9	76.00	23°42'31"	306.88	133.39	S 88°45'10" E
10	295.00	30°04'55"	154.88	153.11	S 43°30'31" W
11	285.00	2°22'01"	141.16	139.82	N 72°25'10" W
12	20.00	90°00'00"	31.42	28.28	N 48°01'58" W
13	20.00	90°00'00"	31.42	28.28	N 48°01'58" W
14	20.00	90°00'00"	31.42	28.28	S 48°01'58" W
15	20.00	90°00'00"	31.42	28.28	N 48°01'58" W
16	50.00	70°51'09"	61.83	57.87	N 50°32'27" E
17	75.00	250°51'09"	308.37	122.23	S 38°27'33" E
18	20.00	90°00'00"	31.41	28.28	S 48°01'58" W
19	20.00	90°10'20"	31.48	28.33	N 48°07'08" W
20	20.00	90°00'00"	31.42	28.28	N 48°02'53" E
21	20.00	90°00'00"	31.42	28.24	N 48°01'58" W

LEGEND:
All dimensions are shown in feet.
All curvilinear dimensions are shown along the arc.
The symbol "o" indicates a concrete monument, which is 4" in diameter x 36" long, encasing a 1/2" iron rod.
The symbol (R) denotes a radial lot line.
All lot markers are 1/2 inch iron rods and are 18 inches in length. (not capped)

Bearings were established from the recorded Plat of "Vista On The Lake Subdivision", Liber 03 of Plats, page 02, Livingston County Records.

PREPARED AND DRAFTED BY:
Boss Engineering Company
3121 East Grand River
Howell, Michigan 48843

GARY R. BOSS
SURVEYOR'S SEAL

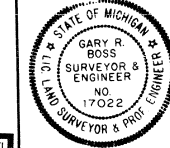

061063

LIBER _____ PAGE _____